



6" HYDRAULIC SUBMERSIBLE PUMP



Specially designed to handle liquids such as sewage and sludge containing solids up to 3" (75 mm) in diameter, the Global Pump 6HYD provides a dependable, high efficiency solution. The 6HYD is a 6" discharge hydraulic submersible pump designed specifically to easily pass through a 22in manhole. It is capable of achieving maximum flows of 1920 US gallons per minute (7267.2 Liters per minute) and 129 feet (39.3m) total head. The standard 6HYD is offered with a trailer mounted hydraulic power unit.

Features

- Compact pump end (will fit through a 21in opening)
- Highway trailer chassis with built in fuel tank and independent suspension
- The engine on the hydraulic power unit features an automatic safety shutdown package
- Variable speed hydraulic drive allows the pump to be operated anywhere within the range of maximum flow capacity and maximum head depending on the application
- High Efficiency Piston Hydraulic Pump
- Compact design with an integral 49 US gallon (186 Liters) fuel tank and a 45 US gallon (170 Liters) hydraulic oil reservoir
- Safe hydraulic drive between the portable power unit and pump end means that it can be used where electric power is hazardous or impractical
- Efficient hydraulic oil cooler
- Pressure relief valve for safe operation
- Submersible pump is not affected by suction lift limitations
- Fluid level/ temperature gauge
- Oil lubricated seals (can run dry)

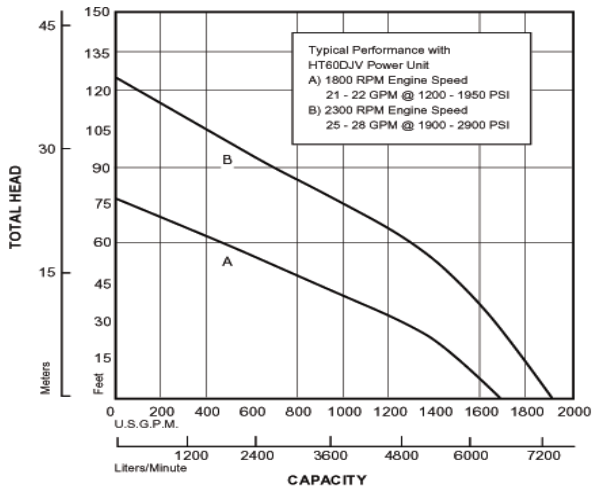
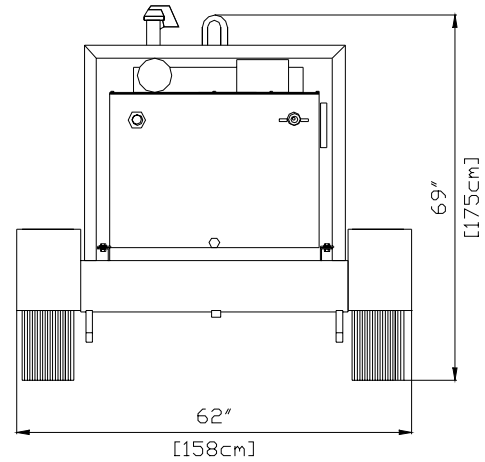
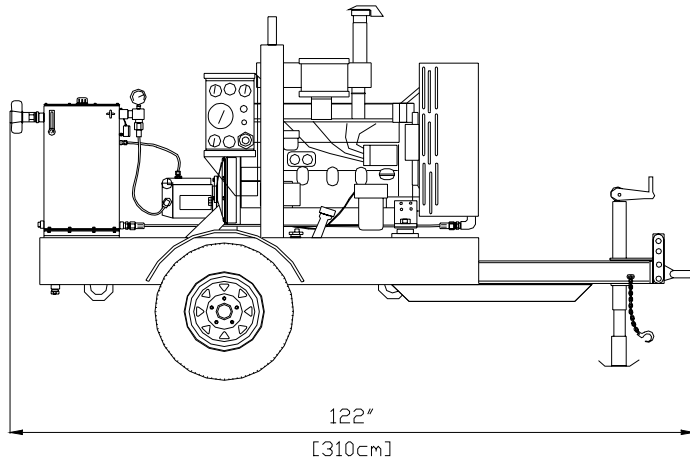

Curves are based on pumping water at 60° F. For Performance Curves other than shown above, Consult Factory.

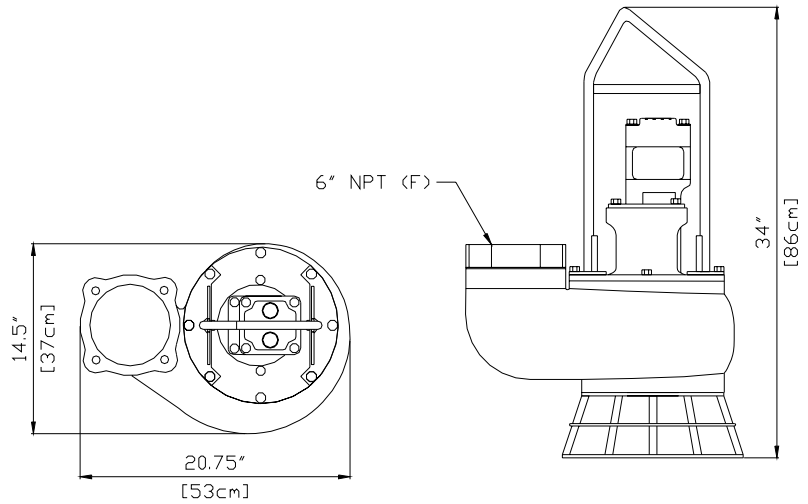

Specifications

- Maximum Operating Pressure:** 2900psi
- Pump End Weight:** 255lbs. (116kg)
- Solids Handling Capability:** 3" (75 mm) diameter using standard impeller
- Maximum Input Flow:** 28 gallons per minute (106 Liters per minute)
- Fuel Consumption:** Approx. 2.8 US gallons per hour (10.6 Liters per hour)
- Integral Fuel Tank Capacity:** 49 US gallons (186 liters), providing approx. 17.5 hours of running time
- Inlet Flange:** 6" 125# ANSI
- Discharge:** 6" NPT(F)

Materials

- Pump Body, Wear Ring, and Impeller:** Ductile Iron
- Pump Drive Shaft:** 17-4PH Stainless Steel
- Shaft Seal:** Carbon/Ceramic (Std.)
Silicon Carbide (Opt.)
- Hydraulic Oil:** SAE 10W or 20W Type AW
- Pump End Elastomers:** Buna N (Std.)

Pumps: Sales, Parts & Service



Global Pump Company

10162 East Coldwater Road, Davison, MI 48423

Tel: (810) 653-4828 Fax: (810) 653-7828

www.globalpump.com